

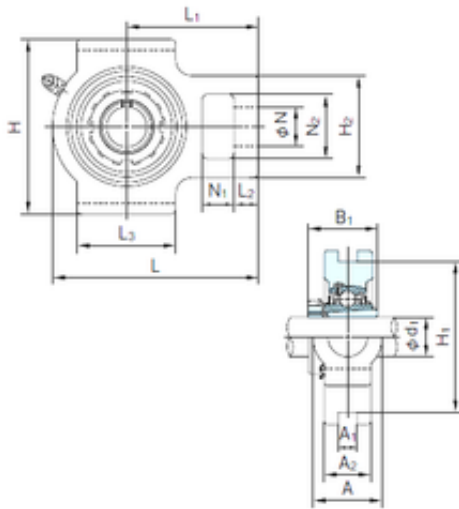

CSC BEARING GROUP limited



NACHI UKTX10+H2310 Bearing unit

Bearing No. UKTX10+H2310

Bore Diameter	45 mm
d	45 mm
L2	19 mm
L3	95 mm
A	64 mm
A1	22 mm
B1	55 mm
H	146 mm
H1	130 mm
H2	102 mm
L	171 mm
L1	106 mm
N	35 mm
N1	25 mm
A2	42 mm
N2	64 mm

UKTX10+H2310 Bearing 2D drawings and 3D CAD models