

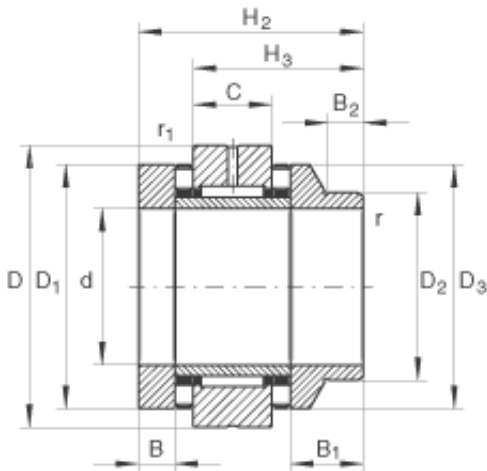

CSC BEARING GROUP limited



30 mm x 62 mm x 10 mm INA ZARN3062-L-TV Compound bearing

Bearing No. ZARN3062-L-TV

ZARN3062-L-TV Bearing 2D drawings and 3D CAD models

| | |
|--------------------|---------------------------------------|
| Size | 30x62x65 mm |
| Bore Diameter | 30 mm |
| Outer Diameter | 62 mm |
| Width | 65 mm |
| d | 30 mm |
| D | 62 mm |
| H ₂ | 65 mm |
| B | 10 mm |
| B ₁ | 25 mm |
| B ₂ | 11 mm |
| C | 20 mm |
| D ₁ | 52 mm |
| D ₂ | 40 mm |
| D ₃ | 50 mm |
| D _{a max} | 53 mm |
| d _{a min} | 38 mm |
| H ₃ | 50 mm |
| r _{1 min} | 0,6 mm |
| r _{min} | 0,3 mm |
| m | 0,75 kg / Weight |
| C _a | 39000 N / Dynamic load rating (axial) |
| C _{0a} | 101000 N / Static load rating (axial) |
| | |



CSC BEARING GROUP limited

| | |
|----------------------|--|
| C_r | 24300 N / Dynamic load rating (radial) |
| C_{0r} | 41500 N / Static load rating (radial) |
| $n_{G\text{OI}}$ | 5500 1/min / Limiting speed for oil lubrication (valid only with adequate oil cooling) |
| $n_{G\text{Fett}}$ | 1800 1/min / Limiting speed for grease lubrication |
| M_{RL} | 0,65 Nm / Bearing frictional torque |
| c_{aL} | 2200 N/ μm / Axial rigidity |
| c_{kL} | 520 Nm/mrad / Tilting rigidity |
| M_m | 1,7 kg x cm ² / Mass moment of inertia for rotating inner ring |
| | 1 μm / Axial runout (The axial runout data for screw drive bearing arrangements are based on the rotating inner ring) |
| | ZMA30/52 / Designation of recommended INA locknut |
| Category | Ball Bearings |
| Inventory | 0.0 |
| Manufacturer Name | SCHAEFFLER GROUP |
| Minimum Buy Quantity | N/A |
| Weight / Kilogram | 0.832 |
| EAN | 4012802453188 |
| Product Group | B00234 |