

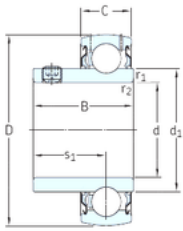

CSC BEARING GROUP limited

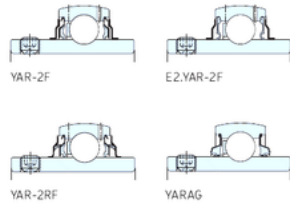

YAT



25,4 mm x 52 mm x 34,1 mm SKF
YAR205-100-2RF Deep ball bearings

Bearing No. YAR205-100-2RF

YAR205-100-2RF Bearing 2D drawings and 3D CAD models

Size	25.4x52x34.1 mm
Bore Diameter	25,4 mm
Outer Diameter	52 mm
Width	34,1 mm
d	25,4 mm
D	52 mm
B	34,1 mm
C	15 mm
d1	33,7 mm
r1 min.	0,6 mm
r2 min.	0,6 mm
s1	19,8 mm
Weight	0,19 Kg
Basic dynamic load rating (C)	14 kN
Basic static load rating (C0)	7,8 kN
Fatigue load limit (Pu)	0,335