

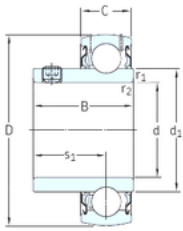

CSC BEARING GROUP limited

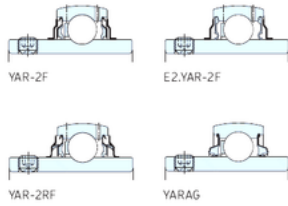

YAT



36,513 mm x 72 mm x 42,9 mm SKF
E2.YAR207-107-2F Deep ball bearings

Bearing No. E2.YAR207-107-2F

Size	36.513x72x42.9 mm
Bore Diameter	36,513 mm
Outer Diameter	72 mm
Width	42,9 mm
d	36,513 mm
D	72 mm
B	42,9 mm
C	19 mm
d1	46,1 mm
r1 min.	1 mm
r2 min.	1 mm
s1	25,4 mm
Weight	0,41 Kg
Basic dynamic load rating (C)	25,5 kN
Basic static load rating (C0)	15,3 kN
Fatigue load limit (Pu)	0,655

E2.YAR207-107-2F Bearing 2D drawings and 3D CAD models