

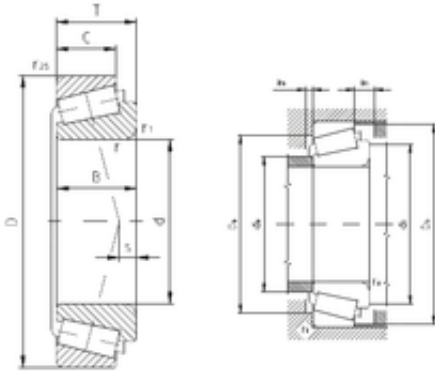

CSC BEARING GROUP limited

17,462 mm x 39,878 mm x 14,605 mm ZVL K-LM11749/K-LM11710 Double knee bearing



Bearing No. K-LM11749/K-LM11710

K-LM11749/K-LM11710 Bearing 2D drawings and 3D CAD models

Size	17.462x39.878x13.843 mm
Bore Diameter	17,462 mm
Outer Diameter	39,878 mm
Width	13,843 mm
d	17,462 mm
D	39,878 mm
T	13,843 mm
B	14,605 mm
C	10,67 mm
r min.	1,3 mm
r1 min.	1,3 mm
r2 min.	1,3 mm
S	4,8 mm
da max	23 mm
Da min	33,5 mm
Da max.	35 mm
db min	24 mm
Db min.	37 mm
ra max.	1 mm
rb max.	1 mm
Weight	0,086 Kg
Basic dynamic load rating (C)	22,2 kN
Basic static load rating (C0)	21,5 kN
(Grease) Lubrication Speed	10 000 r/min
(Oil) Lubrication Speed	13 000 r/min



CSC BEARING GROUP limited

Calculation factor (e)	0,29
Calculation factor (Y)	2,1