

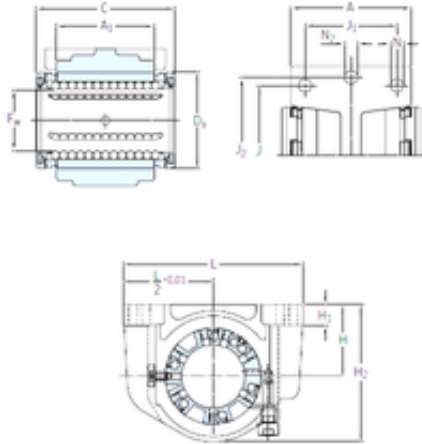

CSC BEARING GROUP limited



SKF LUCS 8 Linear bearing

Bearing No. LUCS 8

Outer Diameter	8 mm
Ew	8 mm
Da	16 mm
A	27 mm
A1	14 mm
C	25 mm
H	15 mm
H1	5,5 mm
H2	28 mm
J	25 mm
L	45 mm
N	3,2 mm
J1	20 mm
J2	35 mm
N2	5,3 mm
Weight	0,028 Kg
Basic dynamic load rating (C)	0,49 kN

LUCS 8 Bearing 2D drawings and 3D CAD models