

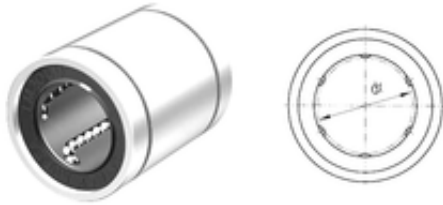

## CSC BEARING GROUP limited



12 mm x 21 mm x 23 mm Samick LM12UU  
Linear bearing

Bearing No. LM12UU

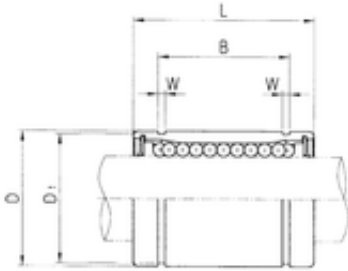

LM12UU Bearing 2D drawings and 3D CAD models

Size	12x21x23 mm
Bore Diameter	12 mm
Outer Diameter	21 mm
Width	23 mm
d	12 mm
D	21 mm
B	23 mm
D1	20 mm
L	30 mm
W	1,3 mm
Weight	0,0315 Kg
Basic dynamic load rating (C)	0,41 kN