

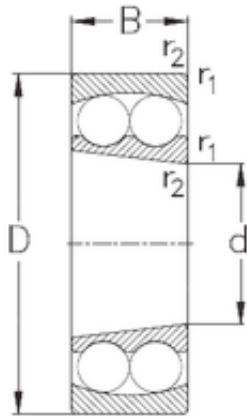

CSC BEARING GROUP limited



95 mm x 200 mm x 67 mm NKE 2319-K Self aligning ball bearing

Bearing No. 2319-K

Size	95x200x67 mm
Bore Diameter	95 mm
Outer Diameter	200 mm
Width	67 mm
d	95 mm
D	200 mm
B	67 mm
C	67 mm
r1 min.	3 mm
r2 min.	3 mm
Weight	10,3 Kg
Basic dynamic load rating (C)	164 kN
Basic static load rating (C0)	64 kN

2319-K Bearing 2D drawings and 3D CAD models