

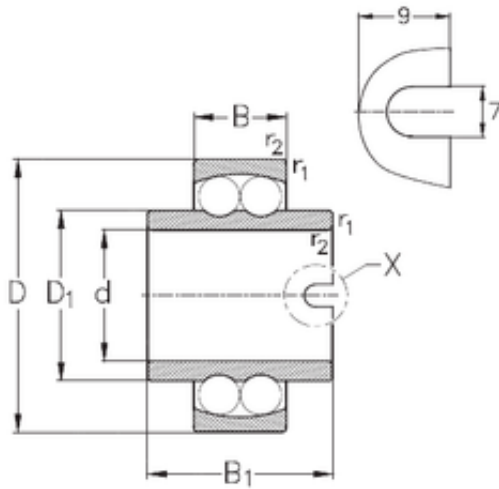

# CSC BEARING GROUP limited

## 45 mm x 85 mm x 58 mm NKE 11209 Self aligning ball bearing



Bearing No. 11209

Size	45x85x58 mm
Bore Diameter	45 mm
Outer Diameter	85 mm
Width	58 mm
d	45 mm
D	85 mm
B	58 mm
C	19 mm
r1 min.	1,1 mm
r2 min.	1,1 mm
D1	57,7 mm
Weight	0,78 Kg
Basic dynamic load rating (C)	23,5 kN
Basic static load rating (C0)	8,2 kN

11209 Bearing 2D drawings and 3D CAD models