

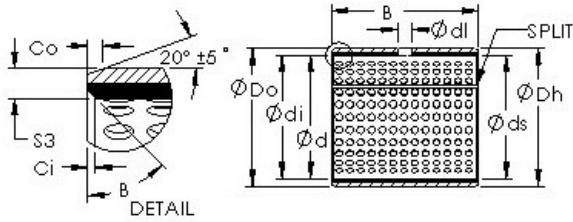

# CSC BEARING GROUP limited



## AST AST20 16IB16 sliding bearing

Bearing No. AST20 16IB16

Bore Diameter	25,4 mm
Outer Diameter	28,575 mm
Bearing Type	straight
Shaft Dia., Nominal (d)	1.0000
Shaft Size (ds)	0.9888 / 0.9876
Housing Bore Dia. (Dh)	1.1258 / 1.1250
Bearing Outside Diameter, Nominal(Do)	1.125
Bearing Bore after Mounting (di)	0.9944 / 0.9912
Average Clearance (Cd)	0.0050
Wall Thickness (S3)	0.067
Bearing Length, Nominal (B)	1.000
Bearing Length Tolerance (B tol.) - +.010 / -0.010	+0.010 / 0.010
OD Chamfer Length (Co)	0.028
ID Chamfer Angle (B deg.)	30
ID Chamfer Length (Ci)	0.020
Lube Hole Dia. (dl)	0.250
Material	Carbon steel shell with POM plastic liner

AST20 16IB16 Bearing 2D drawings and 3D CAD models