

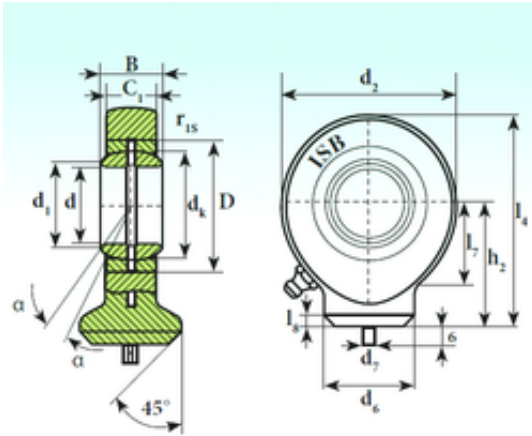

CSC BEARING GROUP limited



T.A.C. 240 Bearing 2D drawings and 3D CAD models

40 mm x 62 mm x 28 mm ISB T.A.C. 240 sliding bearing

Bearing No. T.A.C. 240

Size	40x62x28 mm
Bore Diameter	40 mm
Outer Diameter	62 mm
Width	28 mm
d	40 mm
D	62 mm
B	28 mm
d7	4 mm
d1	45 mm
d2	92 mm
d6	52 mm
dk	53 mm
h2	69 mm
l4 max.	115 mm
l7 min.	48 mm
l8	4 mm
r min.	0,6 mm
C1	23 mm
Angle	7 °
Weight	1,3 Kg
Basic dynamic load rating (C)	100 kN