

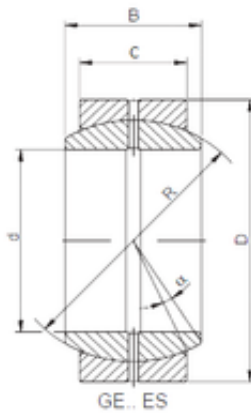

CSC BEARING GROUP limited

20 mm x 42 mm x 25 mm ISO GE20XDO
sliding bearing



Bearing No. GE20XDO

Size	20x42x25 mm
Bore Diameter	20 mm
Outer Diameter	42 mm
Width	25 mm
d	20 mm
D	42 mm
B	25 mm
C	16 mm
Angle	16 °

GE20XDO Bearing 2D drawings and 3D CAD models